





# 유럽형 소켓



## 성능 및 사양

	재질	인증 현황	사용 릴레이	정격전압	내전압	옵션
 <p>KPY2</p>	- Body : PA66 - Terminal : Steel wire	CE RoHS	K705-2PL	300 VAC 10A	3.0kVrms 1min.	- 써지억저버모듈 - 역전압방지모듈
 <p>KPY4</p>	- Body : PA66 - Terminal : Steel wire	CE RoHS	K705-4PL	300 VAC 10A	3.0kVrms 1min.	- 써지억저버모듈 - 역전압방지모듈
 <p>KPZ2</p>	- Body : PA66 - Terminal : Steel wire	CE RoHS	K707-2PL	300 VAC 10A	3.0kVrms 1min.	
 <p>KPZ3</p>	- Body : PA66 - Terminal : Steel wire	CE RoHS	K707-3PL	300 VAC 10A	3.0kVrms 1min.	
 <p>KPY-M1</p>						

\* 써지억저버모듈 : KPY-M1(24VDC/AC), KPY-M2(110VDC/AC), KPY-M3(220VDC/AC)  
 \*\* 역전압방지모듈 : KPY-D(6~250VDC)

**KASYS**

릴레이

안전소켓 P Type

안전소켓 C Type

안전 킥 단자 소켓

유럽형 소켓

MC 수명 체크기

키체커

안전 단자대

소형회로 차단기

# 유럽형 소켓

외형치수도

단위 : mm

KPY2

KPY4

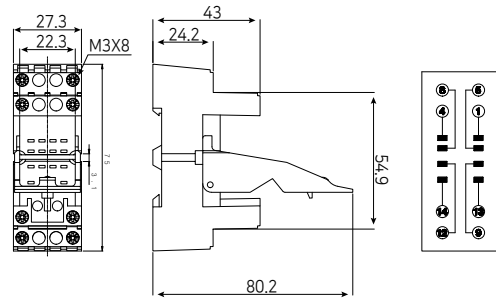
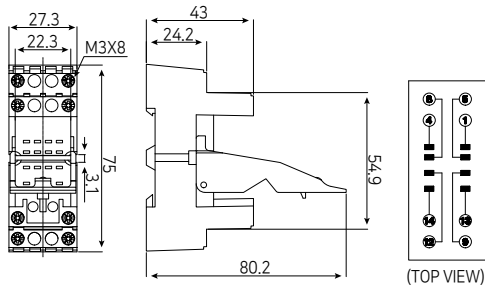

KPZ2

KPZ3

